

DAWSONS

Property Professionals since 1925

18/20 STAMFORD STREET STALYBRIDGE CHESHIRE TEL: 0161 338 2292

Website: www.wcdawson.com Email: reception@wcdawson.com



Lake Road, Stalybridge, SK15 1JE

This well presented, three bedroom, semi detached property comes onto the market in good order throughout having been well maintained and is situated in a popular and convenient residential location. The property is ideally suited to a growing family and has well stocked mature gardens and driveway providing off road vehicular parking. No forward vendor chain.

All local amenities are within easy reach with Stamford Park and Tameside General Hospital also being close to hand. Several junior and high schools are also within easy reach whilst Stalybridge Town Centre is readily accessible and provides a range of shopping and recreational amenities. The Town Centre's bus and train stations provide excellent commuter links. For the security conscious an alarm system is in place.

Price £190,000



**CHARTERED SURVEYORS, ESTATE AGENTS
& PROPERTY MANAGEMENT SPECIALISTS**



Lake Road, Stalybridge, SK15 1JE

- Well Presented, Three Bedroom, Semi Detached
- Popular and Convenient Location
- Driveway Providing Off Road Parking
- Lawned Gardens to Both Front and Rear
- Close to Junior and High Schools
- No Onward Chain
- uPVC Double Glazing/Gas Fired Central Heating
- Internal Inspection Highly Recommended

Contd.....

The property briefly comprises:

Entrance Hallway, through Lounge with feature fireplace, Dining Kitchen with integrated appliances, open rear Hallway area

To the first floor there are 3 well proportioned Bedrooms each with fitted/built-in storage wardrobes, Shower Room/WC with white suite

Externally the front garden is laid to lawn. There is a driveway to the side of the property providing off road parking. The enclosed rear garden has patio and lawned sections and a variety of mature border plants and shrubs.

The Accommodation in Detail:

Entrance Hallway

Double glazed composite style security door

Lounge

16'11 x 11'11 (5.16m x 3.63m)

Feature fireplace with living flame coal effect gas fire, two uPVC double glazed windows, two central heating radiators

Dining Kitchen

16'11 x 7'7 max (5.16m x 2.31m max)

One and a half bowl single drainer stainless steel sink unit, range of wall and floor mounted units, built-in four ring gas hob, built-in oven, integrated dishwasher, plumbed for automatic washing machine, two uPVC double glazed windows, tiled floor, part tiled walls, central heating radiator

Rear Open Hallway Area

uPVC double glazed rear door, downstairs storage cupboard

First Floor:

Landing

Built-in airing/storage cupboard, loft access

Bedroom (1)

11'11 x 9'6 plus door recess (3.63m x 2.90m plus door recess)

Fitted wardrobes with access to further bulkhead storage cupboard, uPVC double glazed window, central heating radiator

Bedroom (2)

8'10 x 6'7 (2.69m x 2.01m)

Built-in storage wardrobe, uPVC double glazed window, central heating radiator

Bedroom (3)

11'1 x 7'7 (3.38m x 2.31m)

Fitted wardrobe, uPVC double glazed window, central heating radiator

Shower Room/WC

White suite having shower cubicle, pedestal wash hand basin, low level WC, fully tiled, tiled floor, uPVC double glazed window, recessed spotlight, central heating radiator

Externally:

The front garden is laid to lawn. There is a driveway to the side of the property providing off road vehicular parking. The fully enclosed rear garden has patio and lawned sections with a wide variety of mature border plants and shrubs.

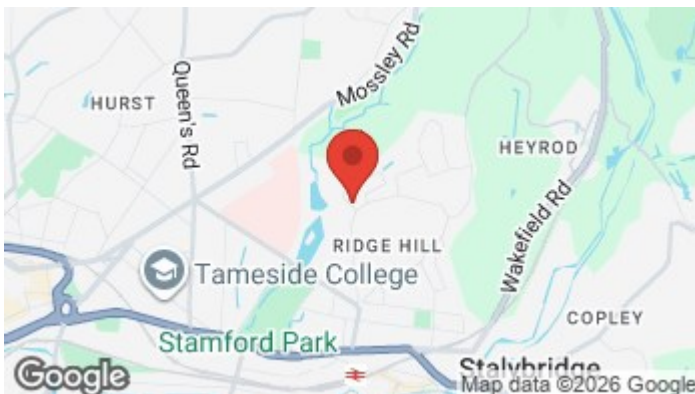

Directions



Floor Plan

Ground Floor

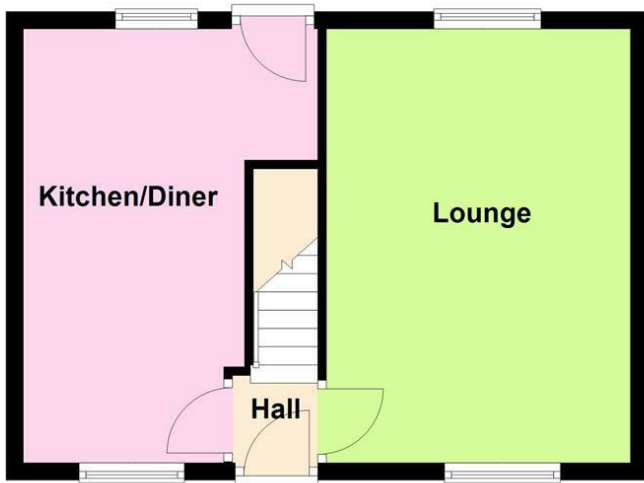

First Floor



These particulars, whilst believed to be accurate are set out as a general outline only for guidance and do not constitute any part of an offer or contract. Intending purchasers should not rely on them as statements of representation of fact, but must satisfy themselves by inspection or otherwise as to their accuracy. No person in this firm's employment has the authority to make or give any representation or warranty in respect of the property.

